

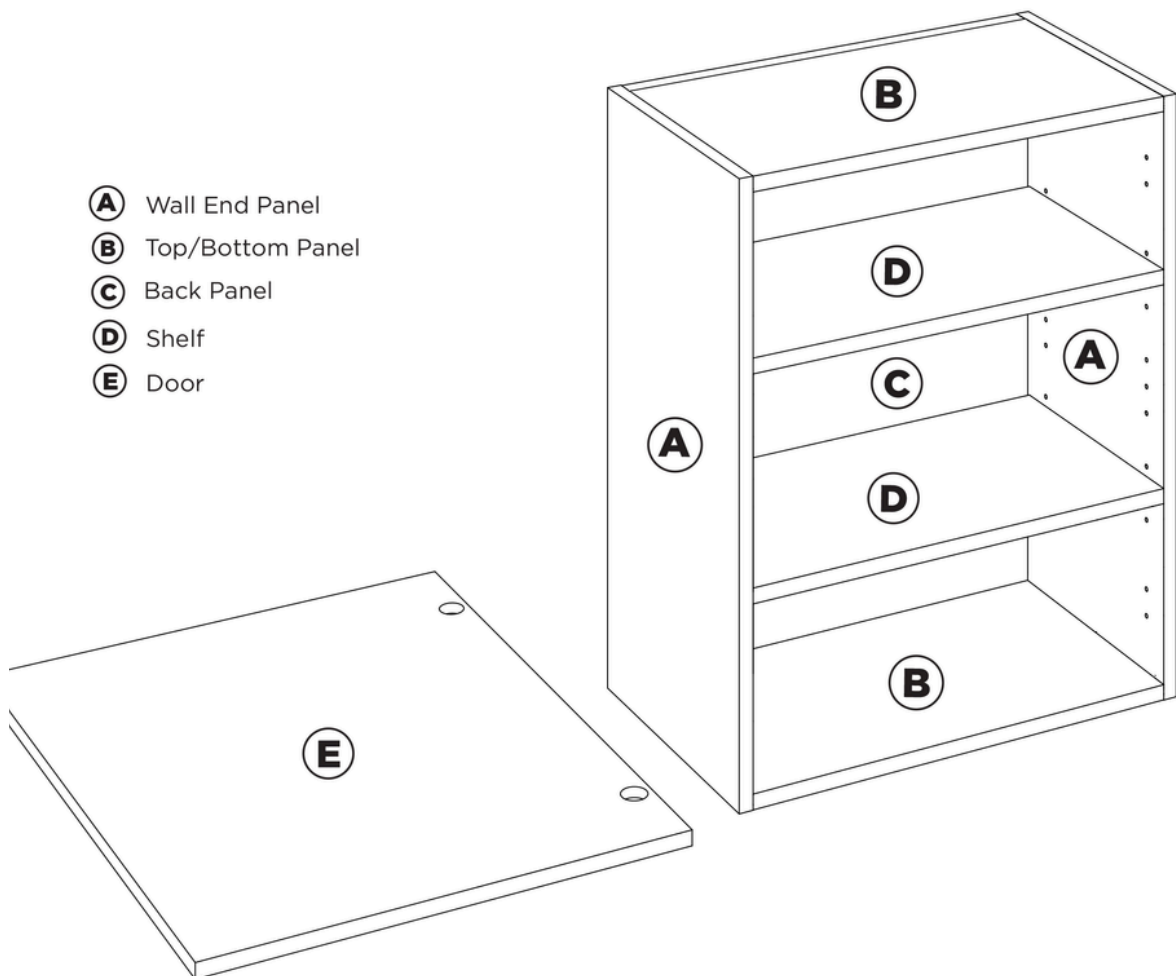

WALL CABINET ASSEMBLY INSTRUCTIONS

- Ⓐ Wall End Panel
- Ⓑ Top/Bottom Panel
- Ⓒ Back Panel
- Ⓓ Shelf
- Ⓔ Door



THE STEP-BY-STEP GUIDE TO INSTALLING YOUR NEW CABINET

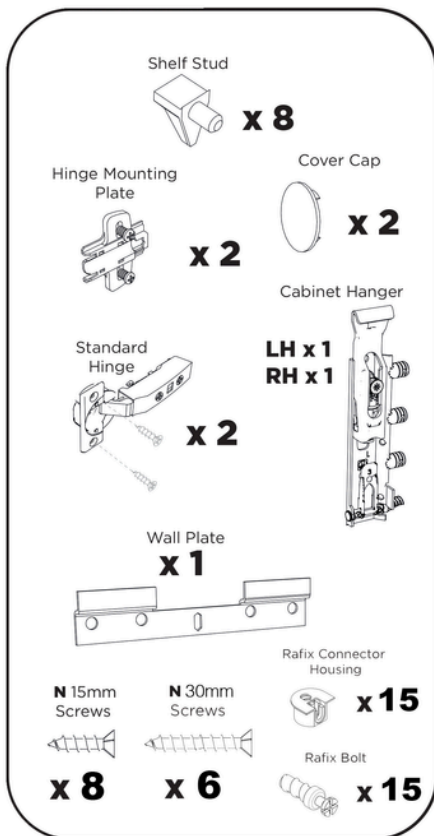

- (A) Wall End Panel
- (B) Top/Bottom Panel
- (C) Back Panel
- (D) Shelf
- (E) Door

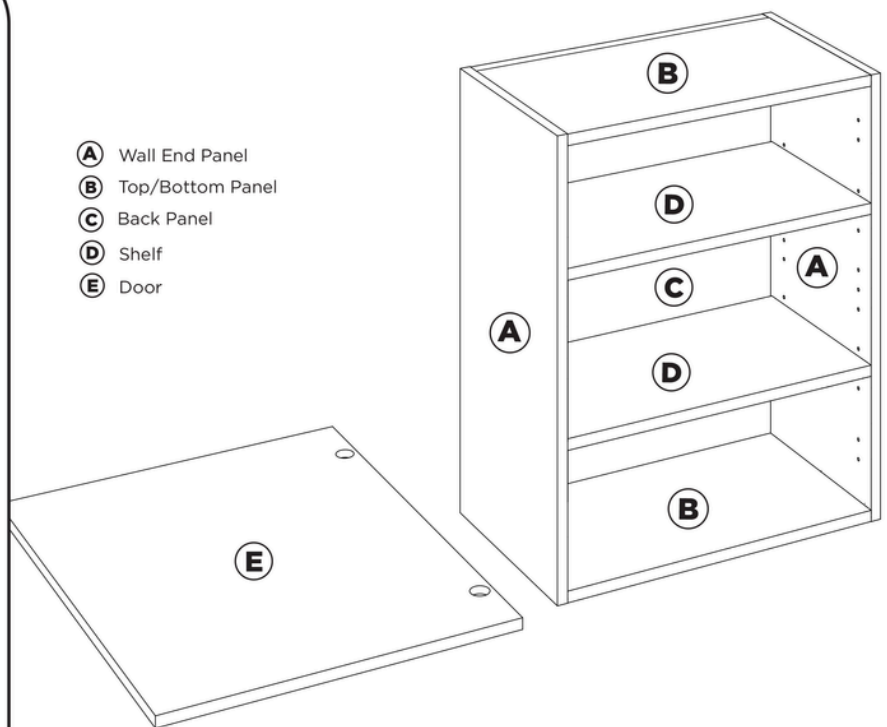

STEP - 1

Insert and screw in the cam (**blue**) and pins (**red**) using a screwdriver and hammer

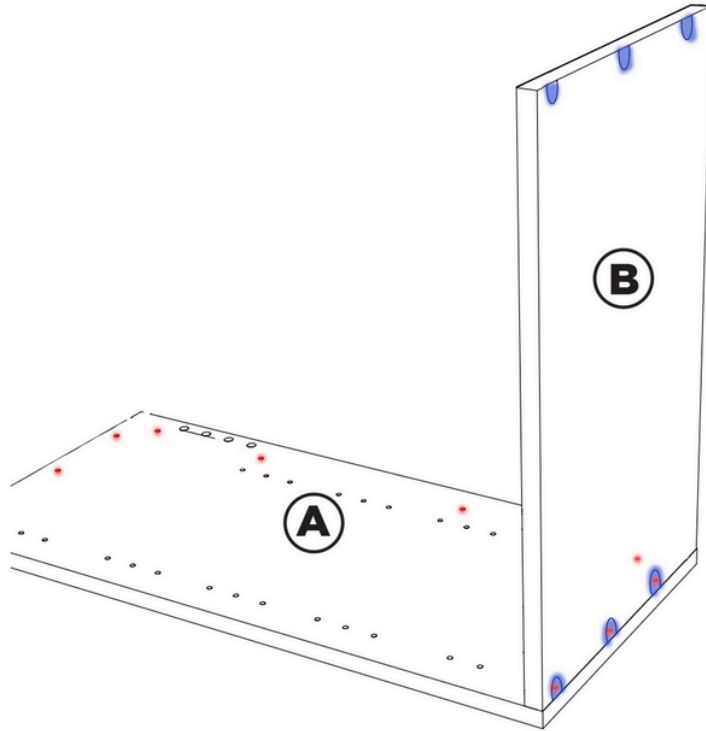

STEP - 2

Align part **B** with **A** using the pin and cam system. Once aligned and inserted, lock the cams using a screwdriver.

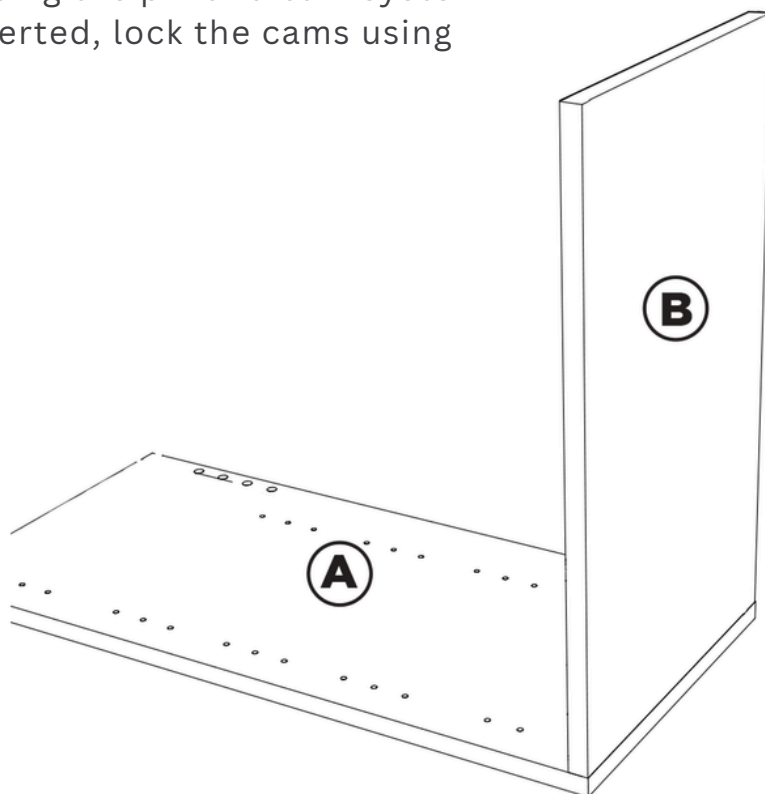

STEP - 3

Align part **C** with Part **A** using the pin and cam system once aligned and inserted lock the cams using a screwdriver.

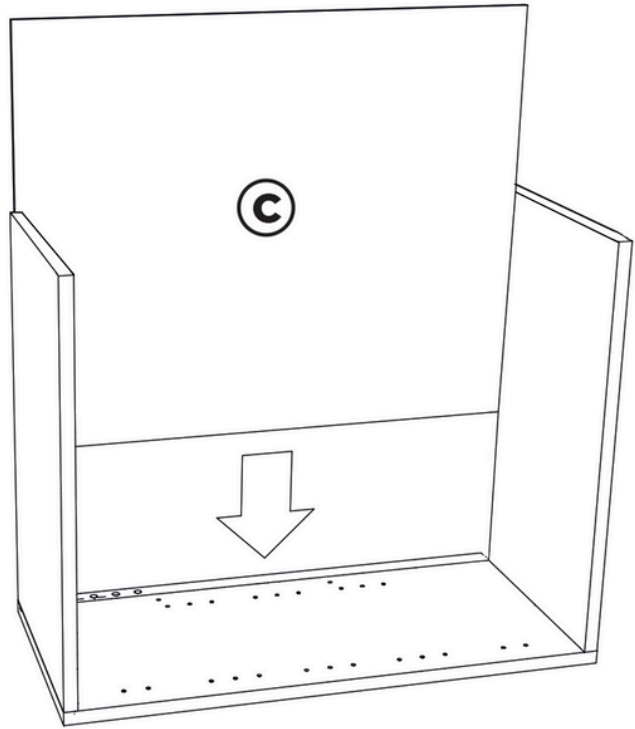

STEP - 4

Align part **A** with the rest of the cabinet using the cam and pin system. Once aligned and inserted, lock the cams using a screwdriver.

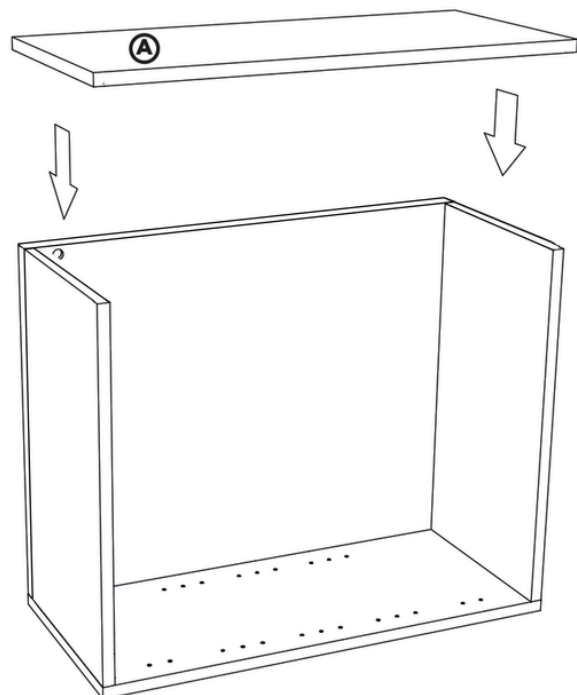

STEP - 5

Insert shelf studs.

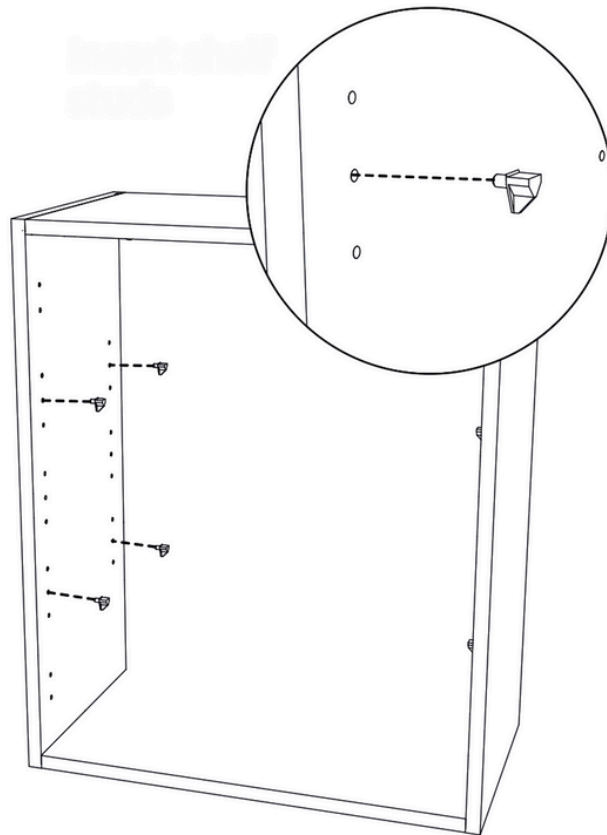

STEP - 6

Slide shelf **D** into position.

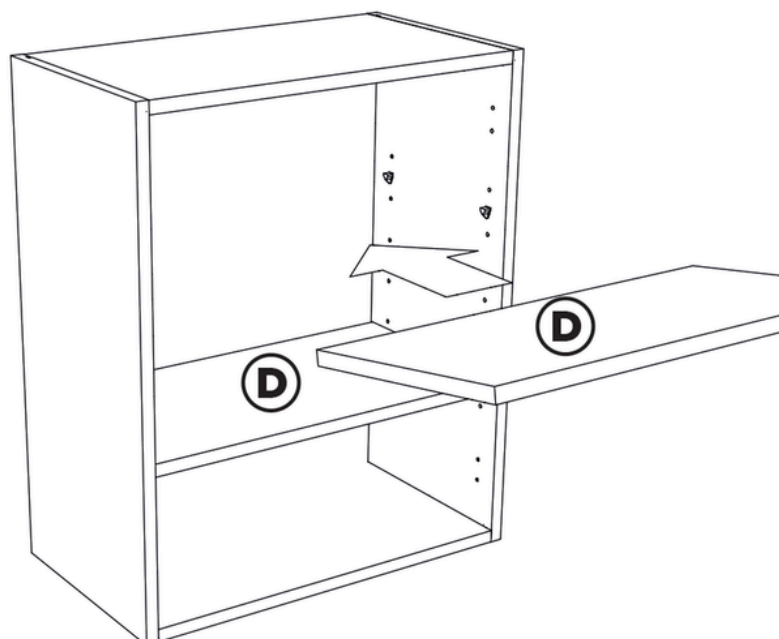

STEP - 7

Screw in the hinge mounting plates with the flat part facing the front of the cabinet.

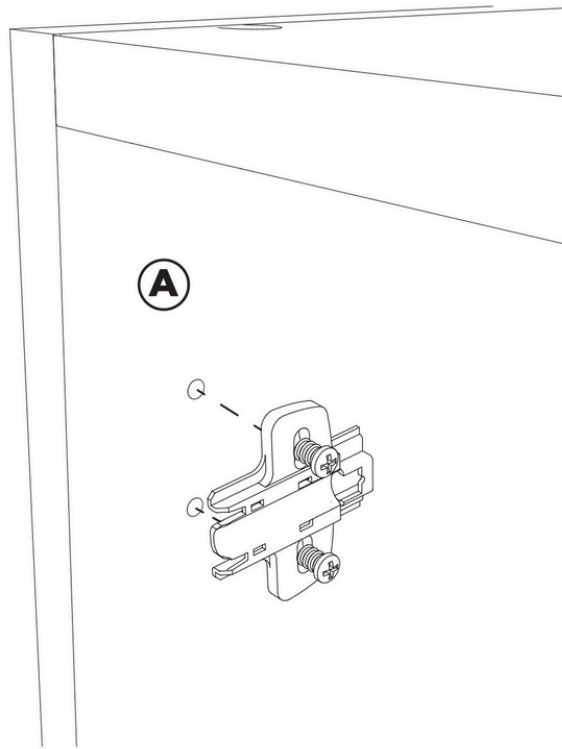

STEP - 8

Ensure the hinge arm is at **90 degrees** to the door, prior fixing it in position with **15mm** screws as shown.

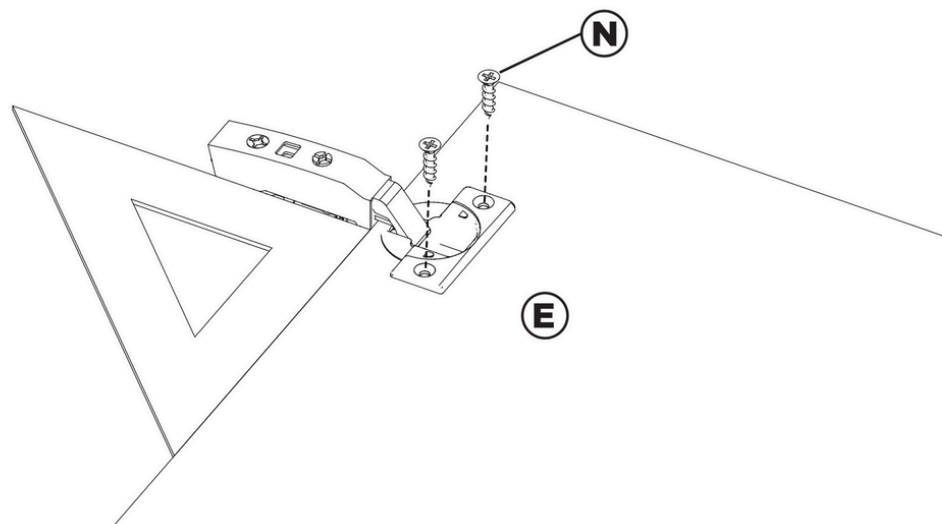

STEP - 9

Hinge adjustment.

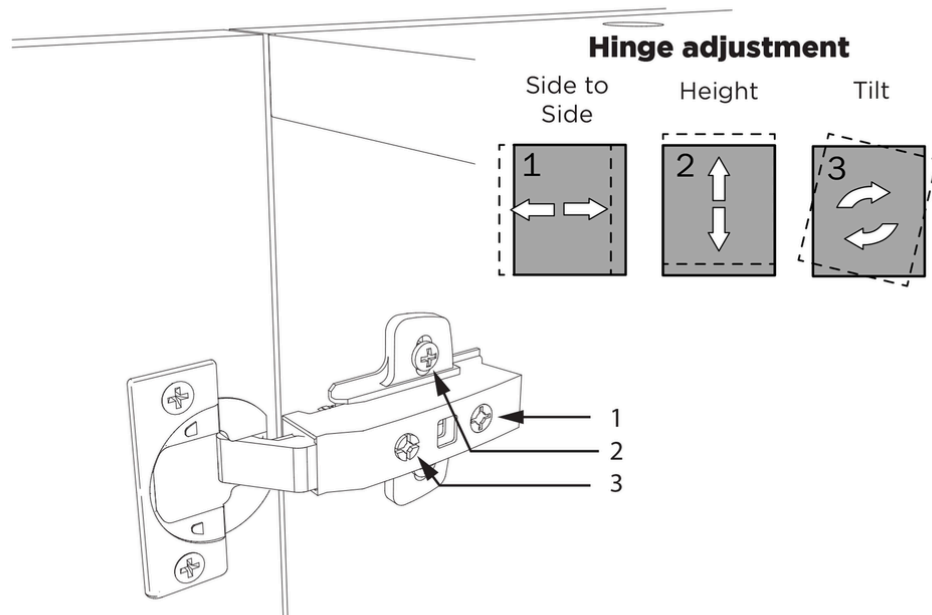

STEP - 10

Screw bracket into position behind the cabinet

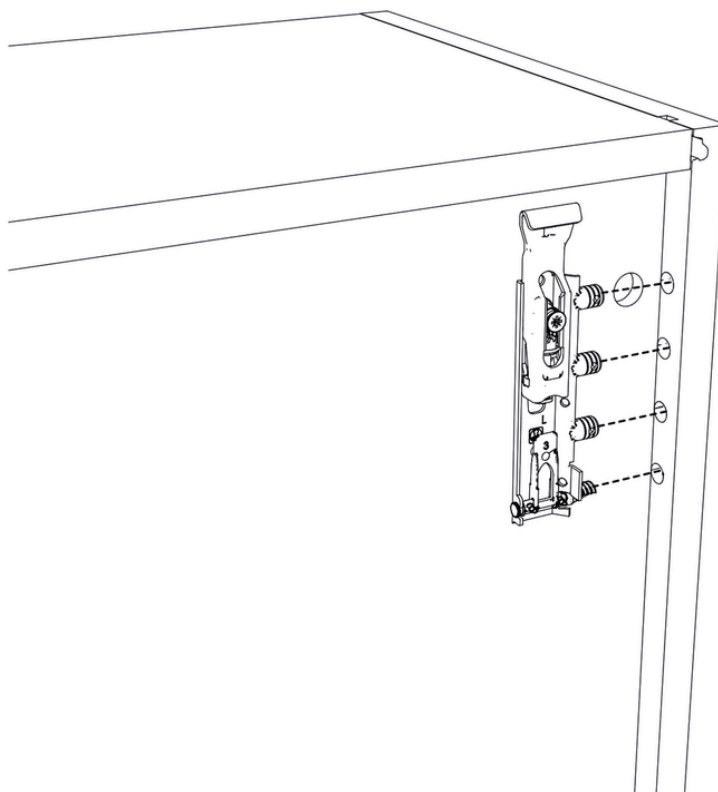

STEP - 11

Lower lever to lock bracket into position.

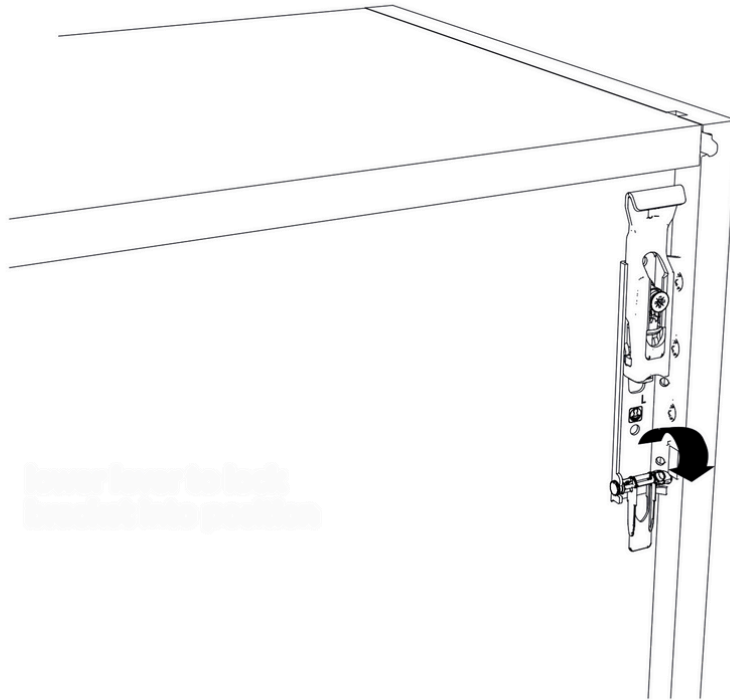

STEP - 12

Attach to wall using appropriate fittings.

Please note, wall fixing screws are not supplied - these should be to suit your type of wall/house build. If in doubt please ask a professional for advice.

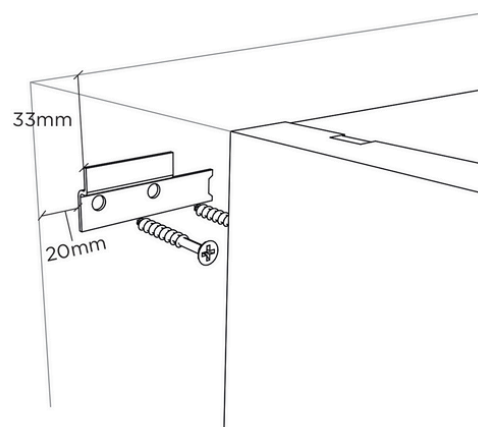
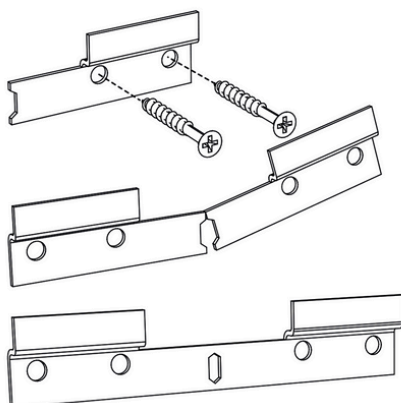

STEP - 13

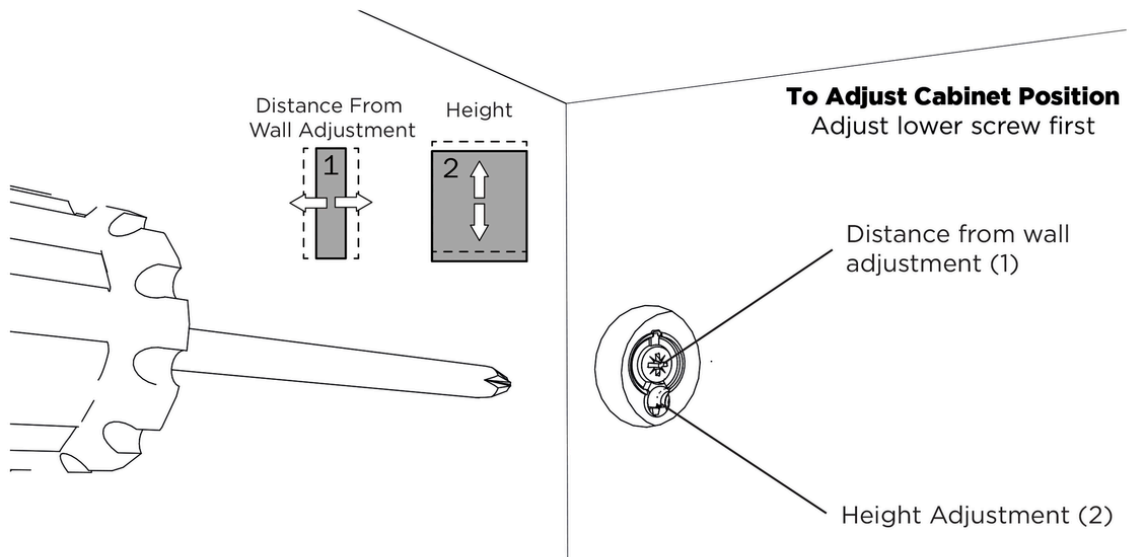

STEP - 14

Fit cover caps.

