

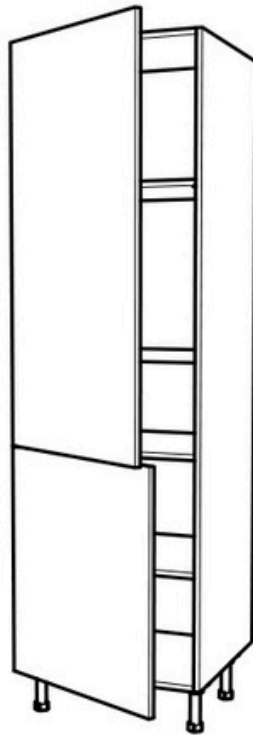

# TALL CABINET ASSEMBLY INSTRUCTIONS



# Introduction

This guide is intended as a supplement to the assembly instructions supplied with individual cabinets. Due to the large variety of door and appliance configurations, a small number of modifications may be needed during installation as shown below.

This avoids the need for multiple drillings to the cabinet, which looks unsightly – and may only be needed on rare occasions.

## NOTE

Ensure all tower cabinets are securely fixed to the wall using appropriate fixings to suit the wall type. See Appendix for more information on fixing cabinets to the wall.

Before you get stuck in; take five minutes to review this installation guide.

Please note the following points:

- Appliance Housing Back Panels will need to be cut to length to suit the chosen unit type – these sizes are shown on individual unit pages.
- In a limited number of configurations, such as drawer and fridge/freezer options, additional drilling is required to the cabinet ends – these positions are shown on individual unit pages.
- Take care to position fixed and adjustable shelves as shown on individual pages.
- Ensure the cabinet is fixed to the wall.

## Back Panels

Back panel heights on appliance housing units vary depending on door configurations – cutting dimensions are shown on individual unit pages.

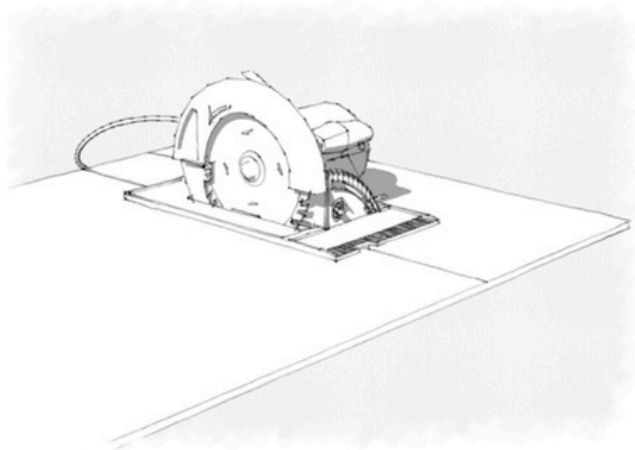

## Shelves

Note that cabinets are supplied with 3x Fixed and 1x adjustable shelf. All appliances must have a fixed shelf above & below them – adjustable shelves are only intended for storage purposes.

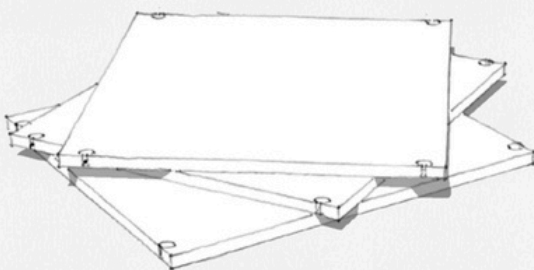

Fixed

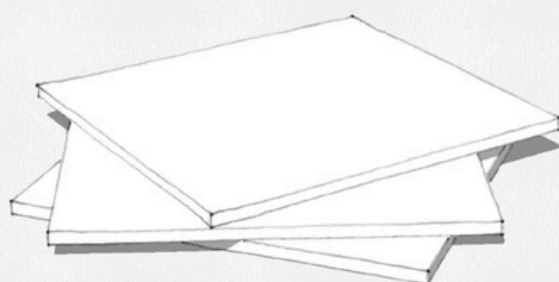

Adjustable

## Appendix

### Fixing cabinets to the wall

Please ensure the cabinet is fixed securely to the wall and also to the adjacent cabinets.

- For 600 wide appliance housing units, this can be done using metal angle brackets or appropriate fixings (not supplied) behind the appliance, before it is slid into position.
- For Larder Units, this can be done at the top of the cabinet, using metal angle brackets or appropriate fixings (not supplied). It is essential that the cabinet is prevented from tipping forward, which could cause injury or damage.

### Fixed Shelves

The fixed shelf system uses a metal camlock housing, together with a screw-in bolt that fixes into the cabinet end panel.

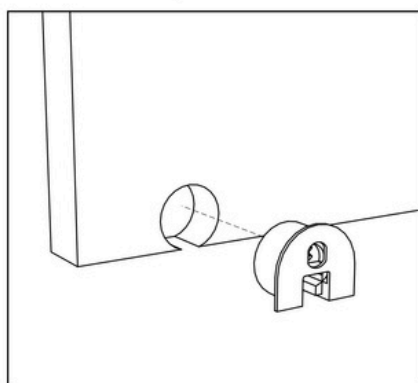

1. Use a soft rubber mallet to tap the Rafix connector housing into the pre-drilled holes.

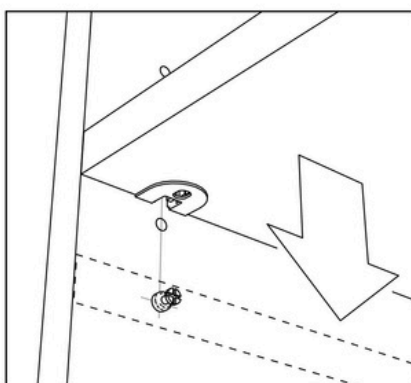

2. The screw-in bolt fixes into the relevant holes in end panel; do not overtighten. The shelf drops into position as shown.

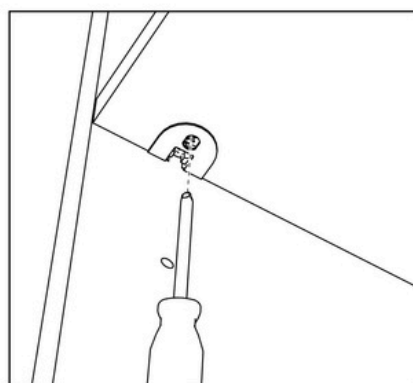

3. Lock off the fittings via the positive screw head inside the Rafix housing.



#### NOTE

*All appliances must be seated on a Fixed Shelf. Never use an adjustable shelf for this purpose.*

# 300 - 600mm Larder Cabinet

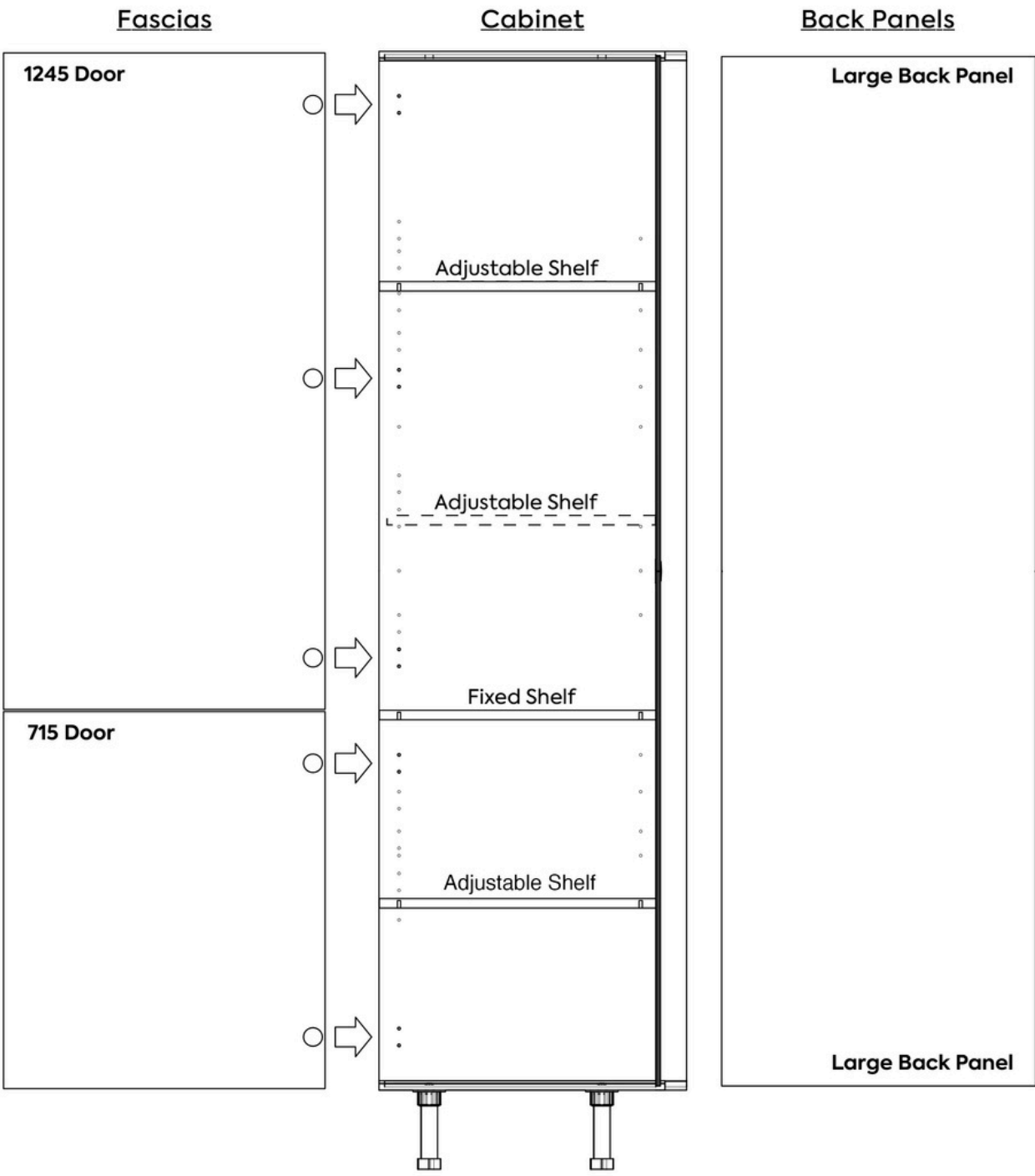
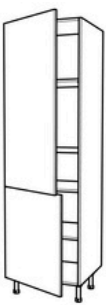

# 600 Single Oven Housing

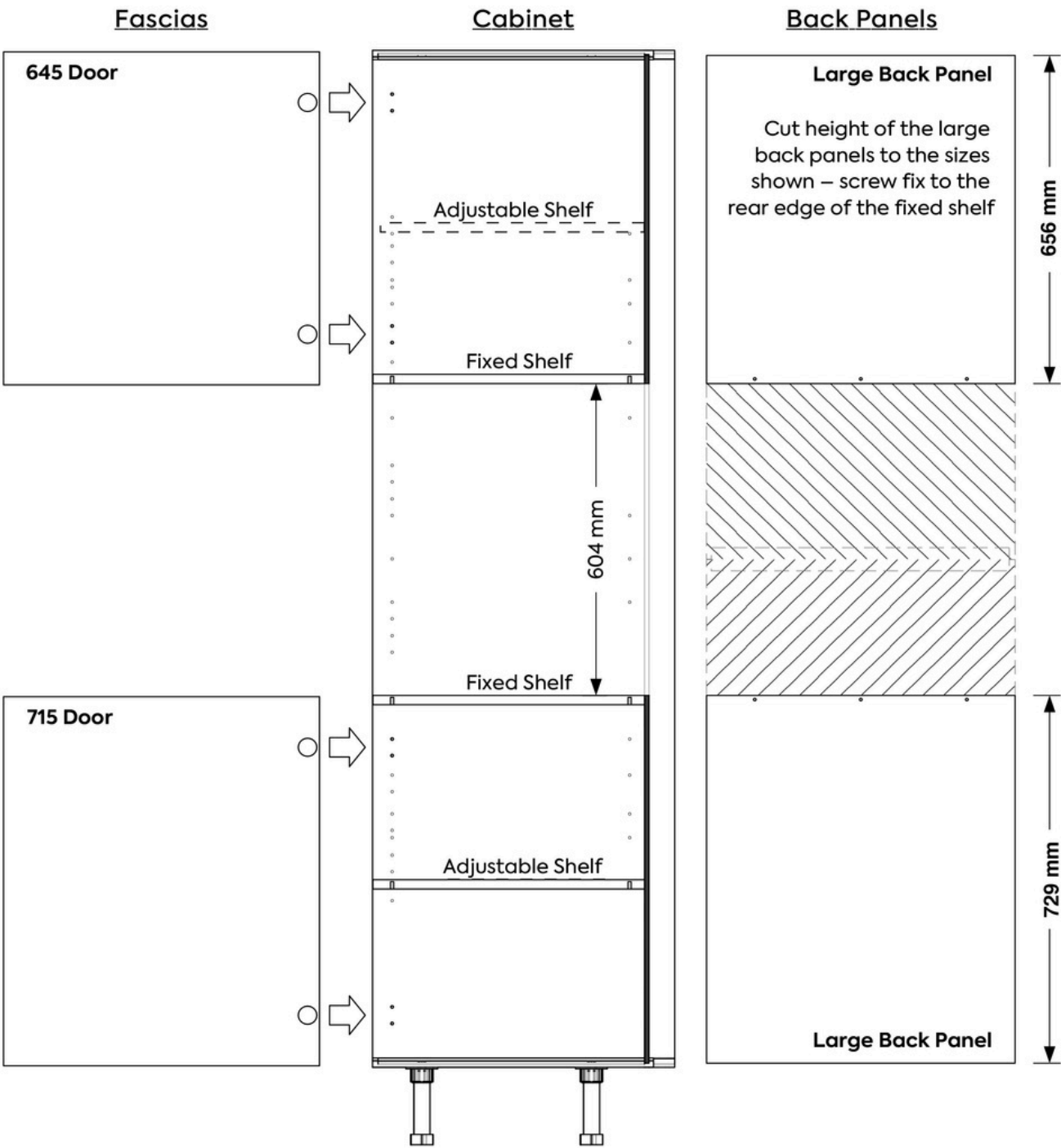
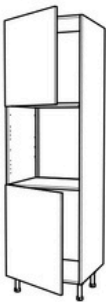

# 600 Oven plus Microwave Housing

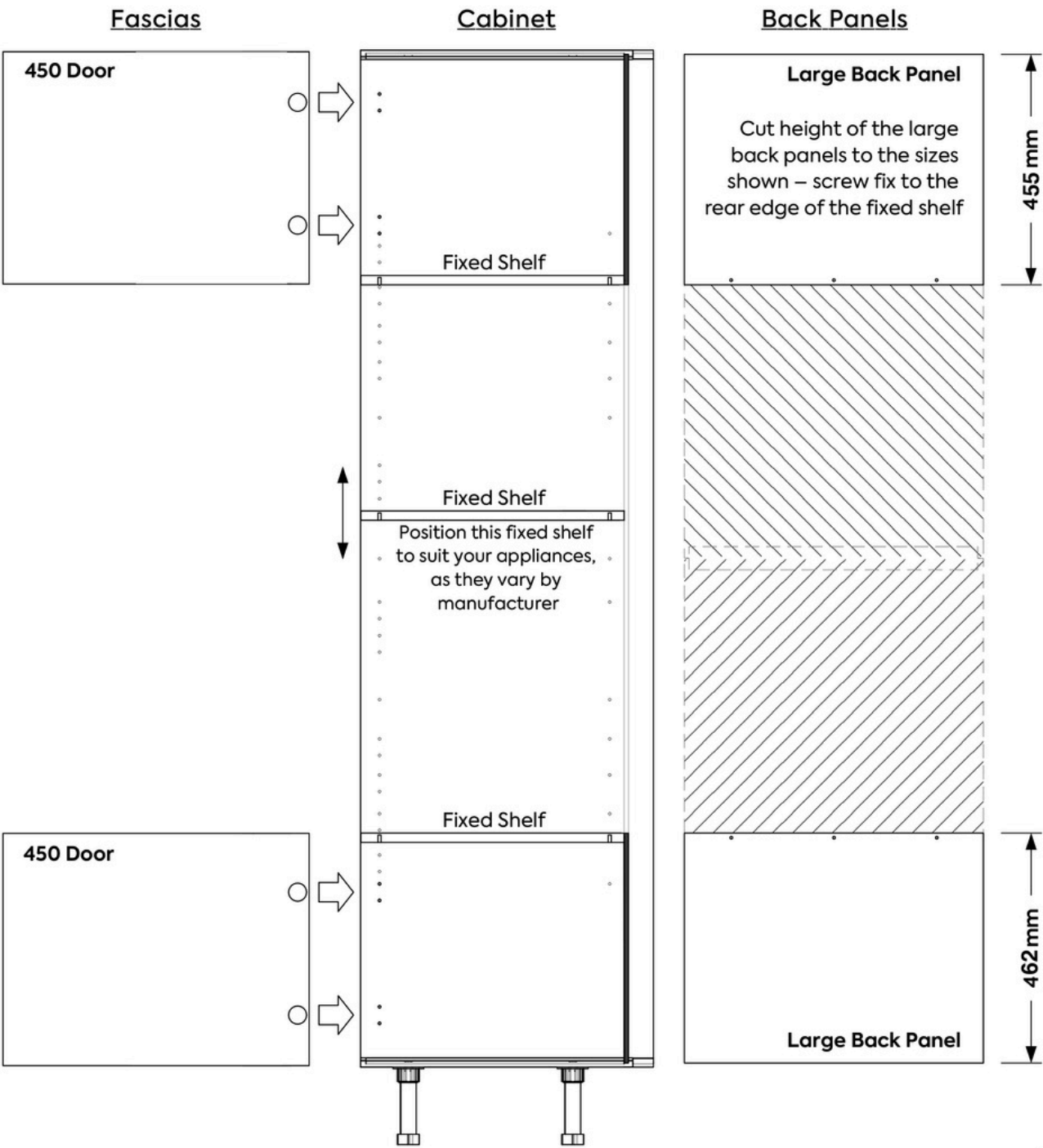
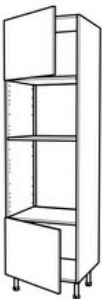

# 600 Double Oven Housing

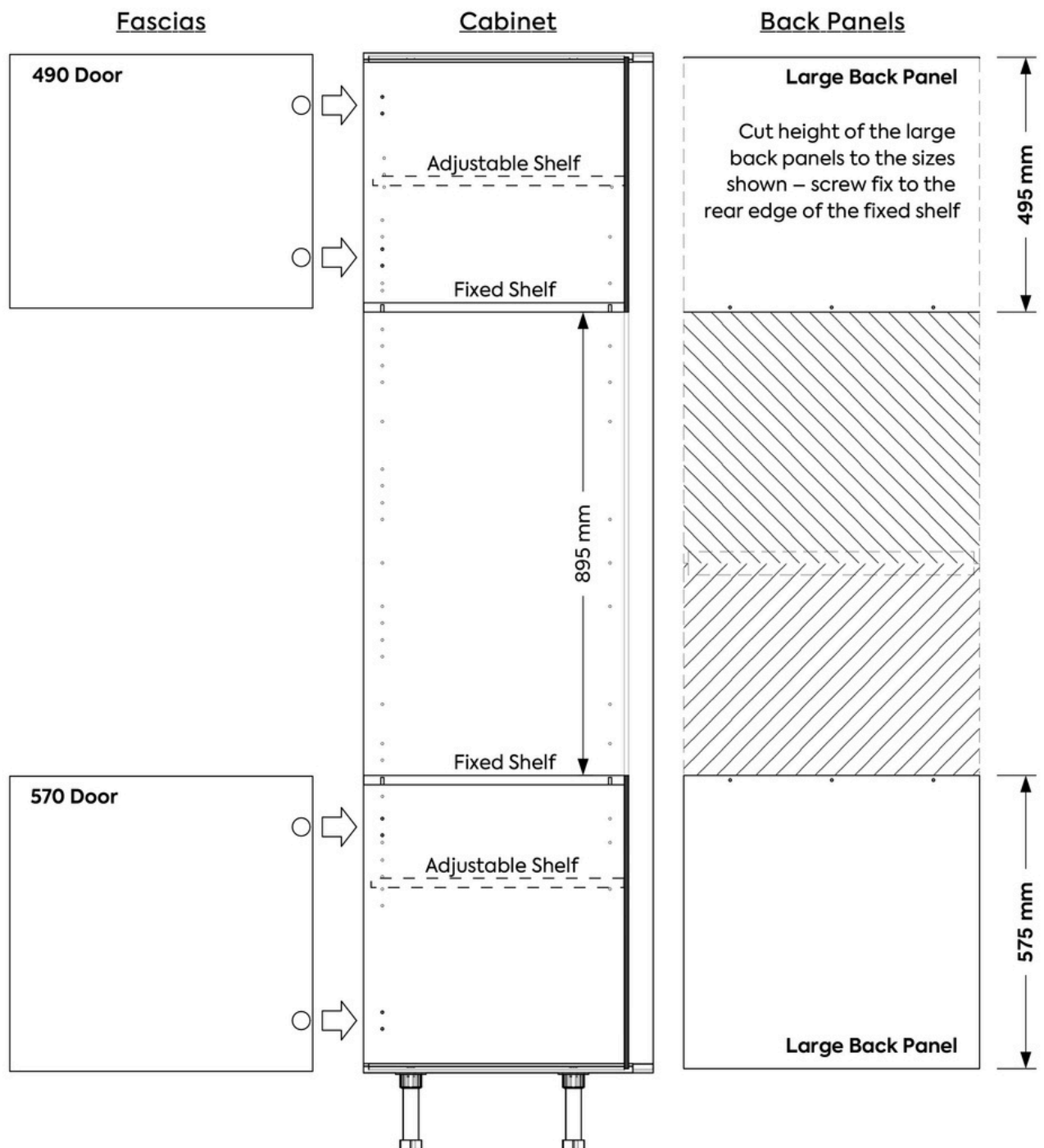

# 600 Fridge & Freezer Housing

